

### 1. Getting Started

#### Kit Contents

- SATA HDD Docking
- USB Cable
- Power Adapter
- Installation CD
- QIG

#### Product Overview

1. Cover
2. OTB Button
3. Caution LED
4. Power LED
5. USB2.0 Port
6. DC Jack
7. Power Switch

#### Minimum System Requirements

- Available OHCI-compliant USB port
- Windows 98SE/ME/2000/XP/VISTA
- MAC OS 9.x or above

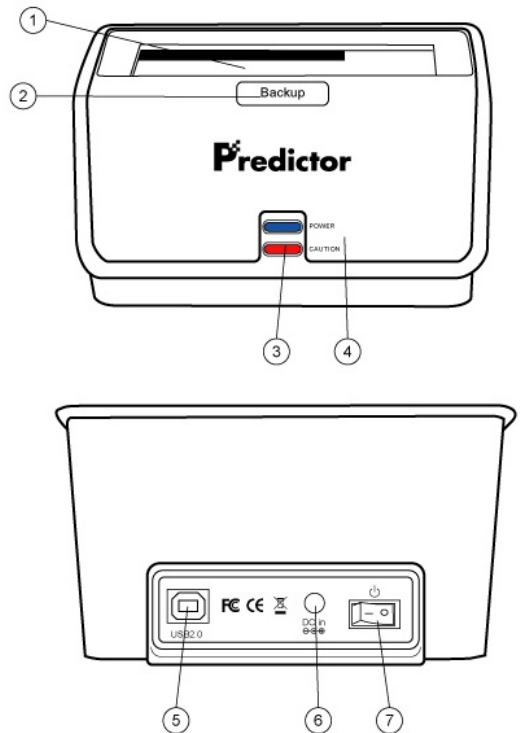

### 2. Assembling the SATA HDD into the Docking

1. The docking supports 2.5" or 3.5" SATA HDD directly plug in to the SATA connector , which is instructed by below photo 1 and 2.
2. You can easily hot-swap the HDD by directly pulling it out from the docking , which is instructed by below photo 3 and 4.

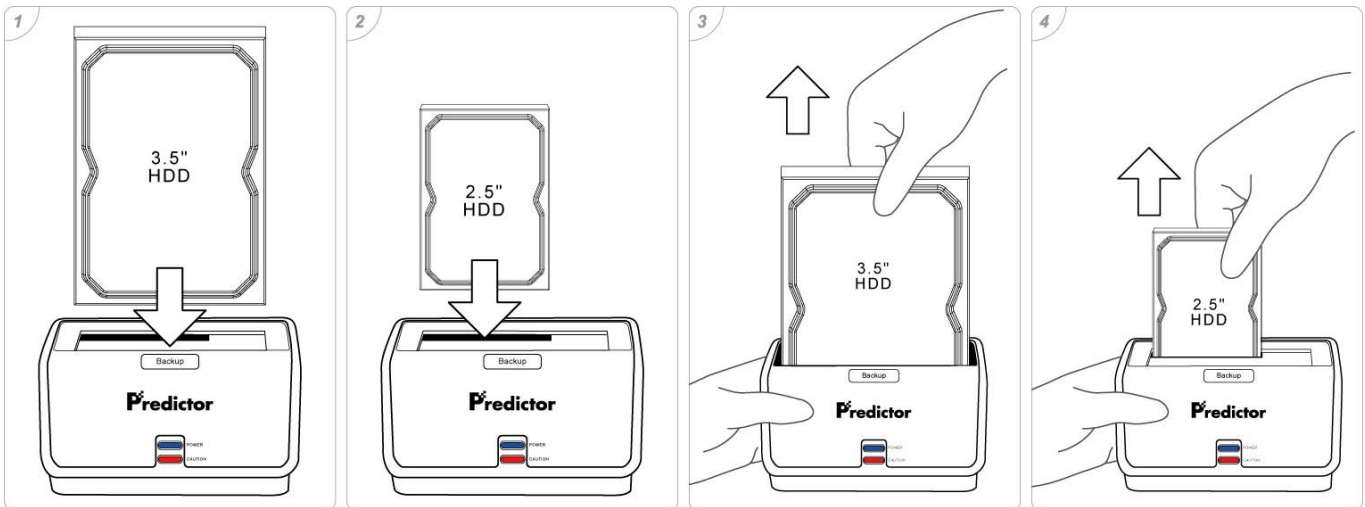

### 3. Connecting the Drive

*Note : If using Windows 98SE , you must install the device driver on your system before connecting the drive.*

1. Connect one end (USB A Type) of the USB Cable to your computer.
2. Connect the other end (USB B Type) of the USB Cable to the USB port on the back of the device.
3. Connect the power adapter to the power socket of the docking and switch the power on.
4. The "Power" LED will illuminate and the presence of an external drive will be visible on your PC monitor or laptop.

### 4. LED indication of the Docking

#### Power LED :

1. The power LED will be illuminated while the power supply is onto the Docking.
2. The power LED will be flashing while Read/Write access to the HDD.

#### Caution LED :

1. The caution LED will only be flashing while the diagnosis of HDD's S.M.A.R.T. attributes is under unreliable status.
2. More S.M.A.R.T. information can be seen by using the S.M.A.R.T. Checkup Tool. (Please refer to below section 5.)

## 5. S.M.A.R.T. Checkup Tool

*Note : S.M.A.R.T. Checkup Tool supports Windows 2000/XP/VISTA only.*

*Note : S.M.A.R.T. Checkup function is embedded in the Docking , it's an auto checkup operation , no need extra software installed.*

1. The caution LED will be flashing only while the HDD's S.M.A.R.T. attributes are close to or below the threshold. This means the HDD is no longer reliable and data backup is suggested or the HDD should be replaced for data protection.
2. By installing S.M.A.R.T. Checkup Tool from CD ROM , user can check the S.M.A.R.T. attributes of the HDD in details.
3. That SMART attributes change slowly over time and are helpful attempts to diagnose the life span of a particular drive.

## 6. Installing OTB Software

*Note : Please select proper OTB .exe version for your computer before installation , OTB supports Windows System only.*

*Note : Please press OTB button for 2 seconds at least to make the copy function work well.*

1. Put Installation CD-ROM into the Optical Drive on your computer or laptop.
2. Select the correct OTB software version and then follow the installation procedures.
3. Once OTB is successfully installed on the computer or laptop, an OTB icon will appear on the system tray of your computer.

## 7. Disconnecting the Drive

*Caution : To prevent data loss always be sure to close all active applications before shutting down the drive.*

### **Windows**

1. Double-click the Safely Remove Hardware icon in your system tray (typically located on the bottom right corner of your desktop).
2. Select the appropriate device from the list and click "Stop". Click "OK" to confirm your selection of the drive to be disconnected.
3. Click "Close" and ensure that the drive is powered off already.

### **MAC**

1. Find the Removable Disk icon associated with the drive that you want to disconnect and drag it to the Trash icon on your desktop.
2. After the disk icon disappears from the desktop and the drive is powered off, you may safely disconnect the USB cable from your computer.

## 8. Remarks

1. The detailed installation manual can be found in the "User Manual" of the CD.
2. The product is compliant with CE/FCC/UL/RoHS/WEEE.
3. Microsoft, Windows 98SE/ME/2000/XP/VISTA are trademarks of Microsoft Corporation. Apple, Macintosh and MAC are trademarks of Apple Computer.